

WPSL Series

LED slim wall packs deliver full cutoff or semi cutoff light distribution. The innovative pivoting head design aims the light precisely and adjusts up to 20 degrees for forward throw illumination. Suitable for up to 25 foot mounting for applications including pathways, perimeter lighting and building entryways. Available in 25W, 35W with CCT 4000K & 5000K. LED wall pack fixtures can be mounted on surface/facade, whether you have a new construction or upgrade application. They are perfect for illuminating a variety of outdoor applications, including facade, wall washing, monuments, landscapes, public places, retail and residential complexes. They provide an added level of security to residential/commercial properties.

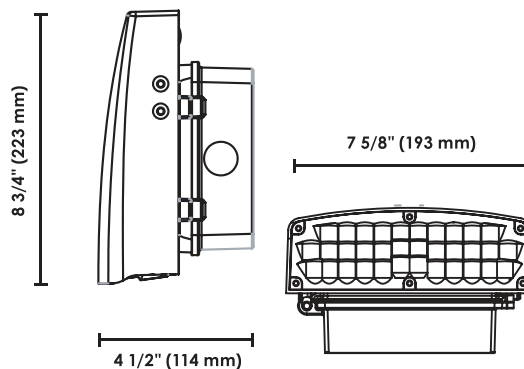

DIMENSION:(mm/in)



WPSL Series

CONSTRUCTION

- Die-cast aluminum housing, fully sealed to be dirt and bug proof
- Light transmission glass lens
- Integral secondary heat sink to optimize thermal transfer and maximize performance and life of LED
- Driver is mounted in direct contact with the casting for a low operating temperature and long life
- Polyester powder-coated finish, rust and corrosion proof
- Stabilized to extreme climate changes without cracking or peeling
- Brown (other finishings are available)

APPLICATIONS

- Wet areas
- Outside walkways
- Farm buildings
(Non-corrosive atmosphere)
- Garages
- Building lighting
- Packing lot lighting
- Entryway
- Storage warehouses
- Security lighting

FEATURES

- ETL/cETL listed for wet and outdoor locations
- 120 lumens per watt
- 100-277VAC input voltage
- 0-10V dimming optional
- Photocell sensor optional



Entryway lighting



Parking lot lighting



Doorways lighting



Building lighting

PRODUCT DETAILS



Integrated level inside the housing to facilitate installation



Built-in photocell sensor



Adjustable tilt up to 90°

WPSL Series

TECHNICAL SPECIFICATION

- Input Voltage : 100-277VAC
- Driver Type : UL High performance LED drive.
- Power factor : >99%, THD <15 %
- Luminous Efficacy : up to 120lm/w
- Colour Rendering Index : > 70Ra
- LED Type : High performance LM80 SMD3030 LED
- Operating Temperature : -30°C up to 50°C (-22°F up to 122°F)
- Color Temperature : 4000K/5000K
- Material : Aluminum Housing & Shatter-Proof Glass Refractor
- Ingress Protection : IP65
- Impact Rating : IK08
- Rated Life : 50,000 hours
- Warranty : 5 years

Models

For example (KLWPSL070-50KFP)

Family	Wattage	Separator	CCT	Angle	Driver Type
KLWPSL: KILI-LED Glass Refractor LED Wall pack (100-277VAC)	025:25W 035:35W	—	30K:3000K 40K:4000K 50K:5000K	C: Full-cut off	P: 1-10v dimming

Produce Code	KLWPSL25	KLWPSL35
Power Consumption(W)	25W	35W
Lumens Delivered (lm)	3000lm	4200lm
Efficacy (lm/W)	120lm/w	120lm/w
CRI	70	70
Color Temperature	4000K/5000K	4000K/5000K
Power Factor	0.95	0.95
Housing	Die-cast aluminum body(Bronze/Black). glass diffuse	Die-cast aluminum body(Bronze/Black). glass diffuse
Input Voltage	100-277VAC	100-277VAC
Installation	Recessed outlet box or wall surface	Recessed outlet box or wall surface
Operating Temperature	-30°C up to 50°C (-40°F up to 122°F)	-30°C up to 50°C (-40°F up to 122°F)
Certification	ETL/cETL	ETL/cETL
Warranty	5 years	5 years

LUMINAIRE PHOTOMETRIC

Cone illuminance Diagram:

	Evag,Emax	Diameter
1.2m	293lx,632lx	240cm
2m	109lx,235lx	393cm
3m	48lx,105lx	588cm
4m	27lx,59lx	785cm

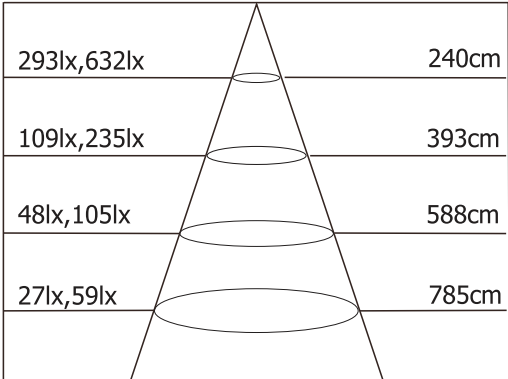

Luminous Intensity Distribution Diagram:

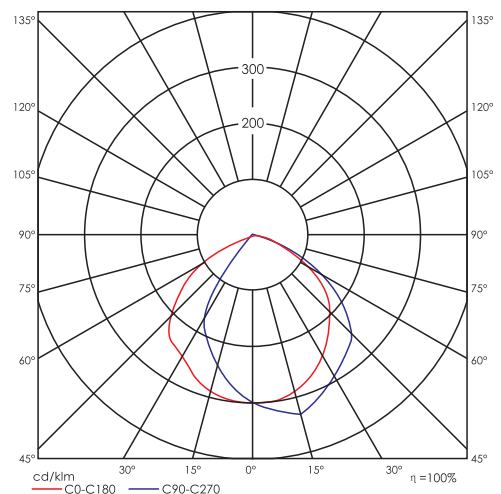

WPSL Series

Wall pack lights sales champion,
quality is better than peers.

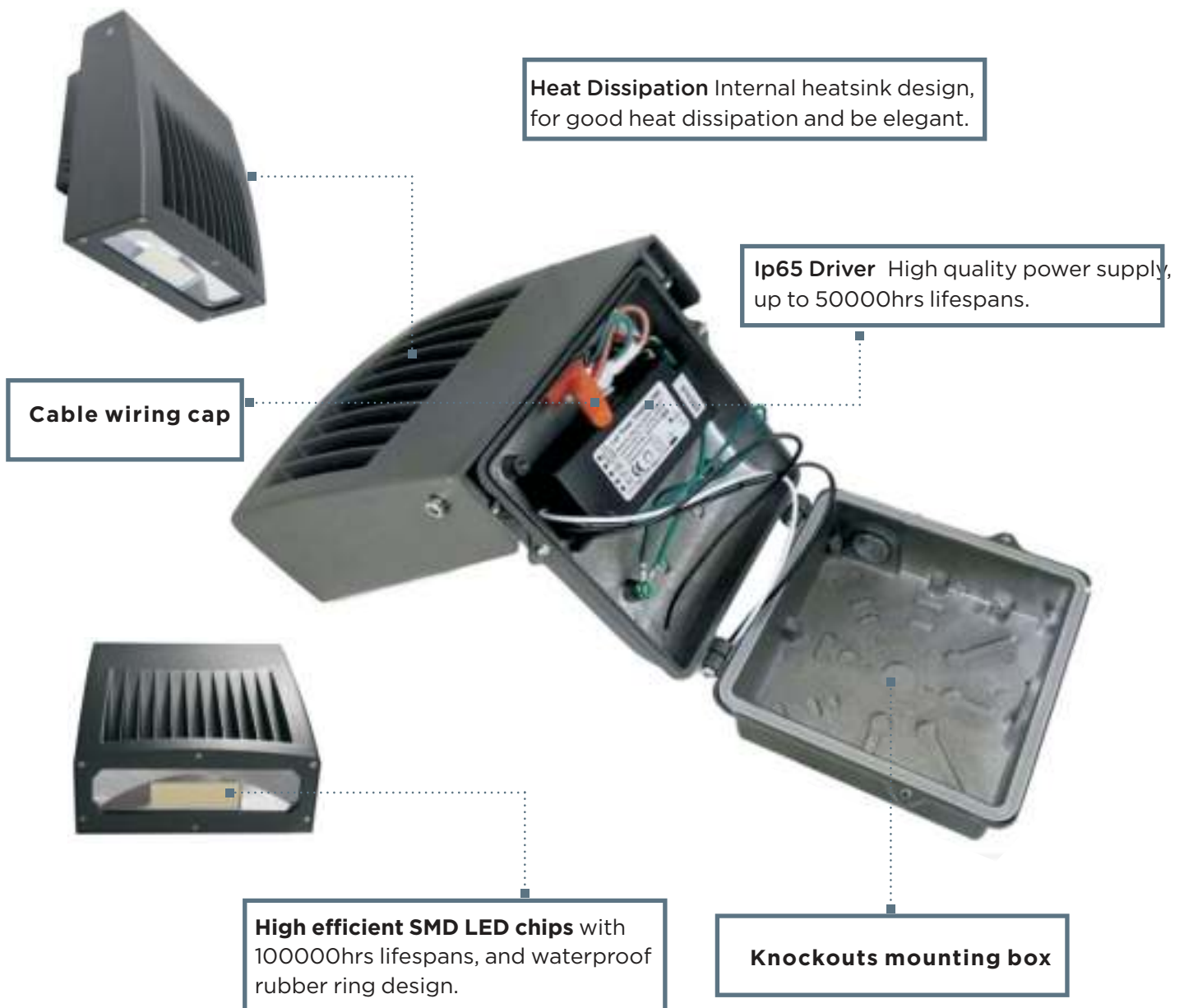

Fixtures and electrical components are UL certified to USA and Canada standards;

- IP65 rated and suitable for wet locations
- Adjust angle from full cut off to half cut off
- 5 years warranty

WPSL Series

PACKAGING

Model No.	Qty (pcs)	L*W*H (CM)	NW. (kgs)	G.W. (kgs)	Meas. (CBM)
			Per CTN	Per CTN	Per CTN
KLWPSL25	4	42*42*28cm	6.5	8.5	0.05
KLWPSL35	4	42*42*28cm	6.5	8.5	0.05